

F102H/M102H SERIES

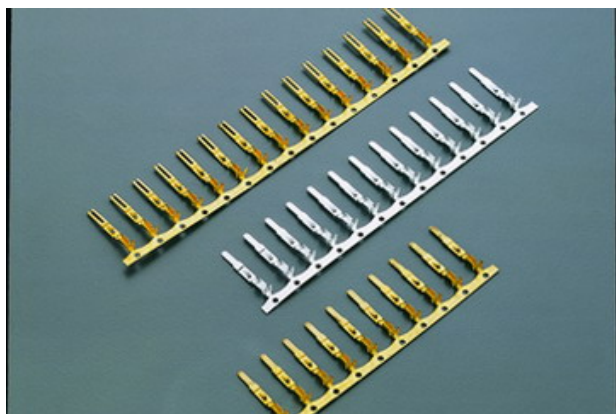

Specifications

Current rating: 3A AC,DC

Voltage rating: 250V AC,DC

Temperature range: -25°C to $+85^{\circ}\text{C}$

(including temperature rise)

Contact resistance: Initial value/10m Ω Max.

After environmental testing/20m Ω Max.

Insulation resistance: 500M Ω MIN.

Withstanding voltage: 1000V AC/minute

Applicable wire: AWG#24-26

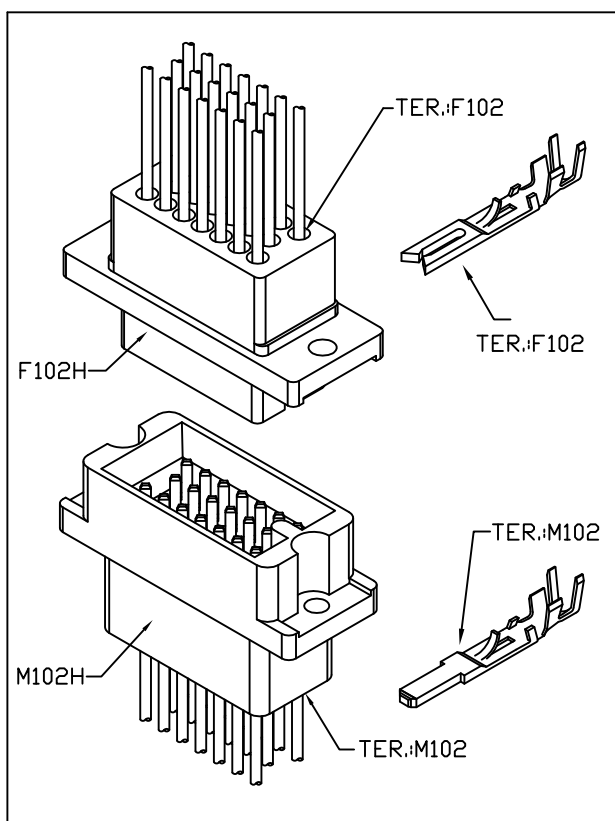

Assembly layout

F102A ELECTRIC & MOTOR PARTS TERMINAL

Features:

unit:mm

- * THICKNESS: 0.3mm
- * MAT'L: BRASS TIN PLATED
- * ACCEPT WITH F102H SERIES HOUSING

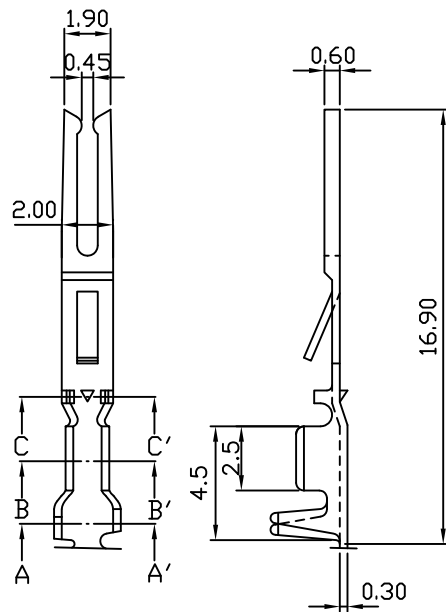
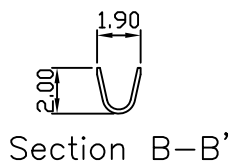
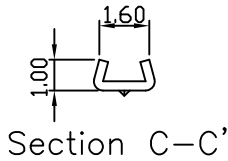
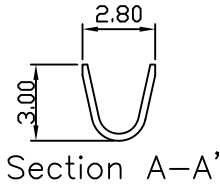

PART NO.	WIRE RANGE	INSULATION O.D.	MATERIAL	FINISH	QTY/REEL
F102A	AWG#24-#26	ø1.5~ø1.2mm	BRASS	Tin-plated	10,000

M102A ELECTRIC & MOTOR PARTS TERMINAL

Features:

unit:mm

- * THICKNESS: 0.3mm
- * MAT'L: BRASS TIN PLATED
- * ACCEPT WITH M102H SERIES HOUSING

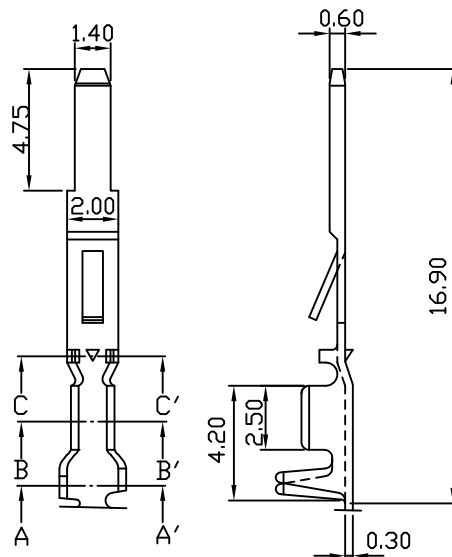
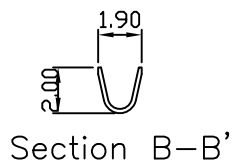
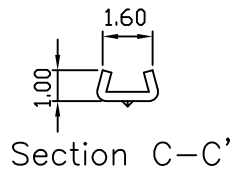
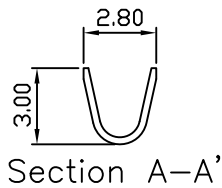

PART NO.	WIRE RANGE	INSULATION O.D.	MATERIAL	FINISH	QTY/REEL
M102A	AWG#24-#26	ø1.5~ø1.2mm	BRASS	Tin-plated	10,000