

# 2532D .098" (2.5mm) PITCH Headers—Straight

Features:

unit:mm

- \* MAT'L: BODY: NYLON 66 UL94V-0  
PINS: BRASS TIN PLATED
- \* MATES WITH: 2531 SERIES TERMINAL
- \* ACCEPTS WITH: 2530 SERIES HOUSING
- \* BOSS TYPE IS INSERTED
- \* AT THE RIGHT SIDE OF P.C.B

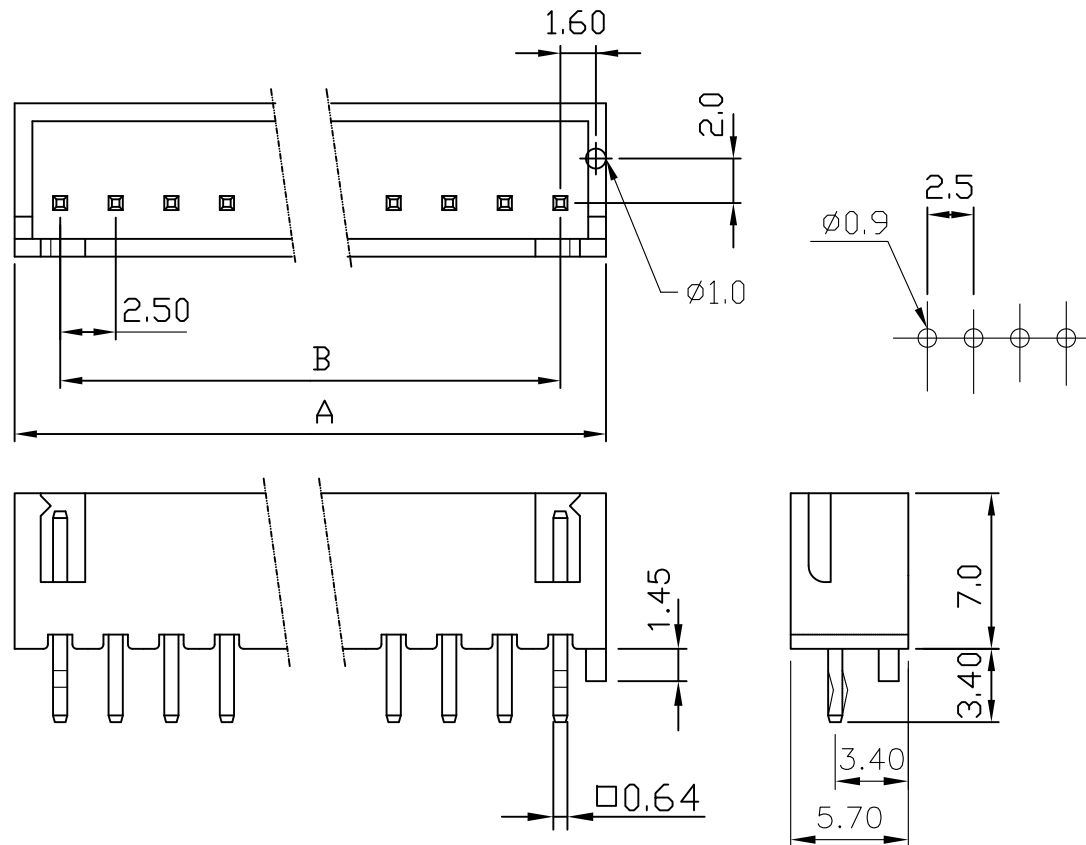

PART NO.	A	B
2532D-02	7.5	2.5
2532D-03	10.0	5.0
2532D-04	12.5	7.5
2532D-05	15.0	10.0
2532D-06	17.5	12.5
2532D-07	20.0	15.0
2532D-08	22.5	17.5
2532D-09	25.0	20.0
2532D-10	27.5	22.5
2532D-11	30.0	25.0
2532D-12	32.5	27.5
2532D-13	35.0	30.0
2532D-14	37.5	32.5
2532D-15	40.0	35.0
2532D-16	42.5	37.5
2532D-17	45.0	40.0
2532D-18	47.5	42.5
2532D-19	50.0	45.0
2532D-20	52.5	47.5