

M102A ELECTRIC & MOTOR PARTS TERMINAL

Features:

unit:mm

- * THICKNESS: 0.3mm
- * MAT'L: BRASS TIN PLATED
- * ACCEPT WITH M102H SERIES HOUSING

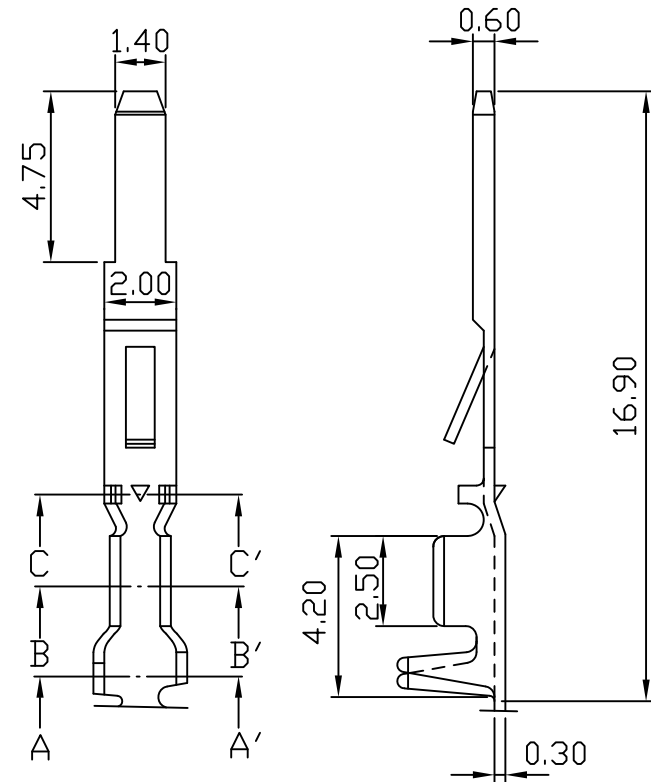
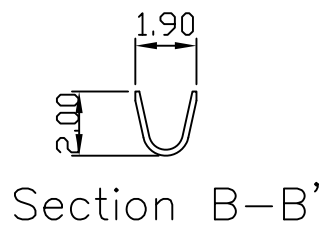
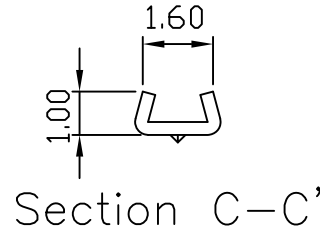
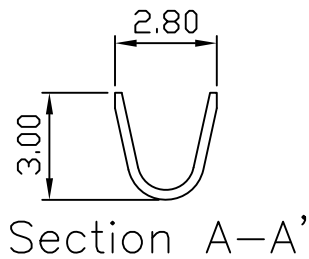

PART NO.	WIRE RANGE	INSULATION O.D.	MATERIAL	FINISH	QTY/REEL
M102A	AWG#24-#26	φ1.5~φ1.2mm	BRASS	Tin-plated	10,000