

2050H SERIES

.079" (2.0mm) WIRE TO BOARD CONNECTOR

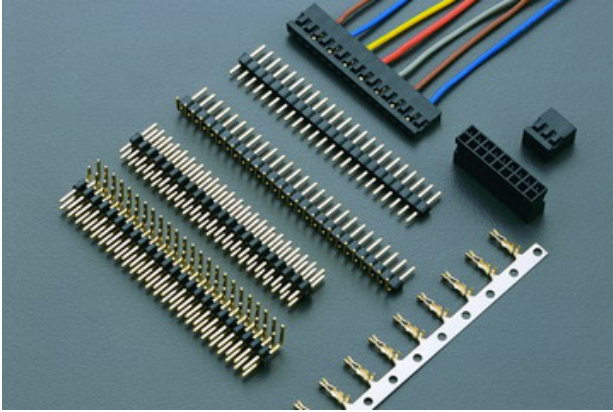

Specifications

Current rating: 1A AC,DC

Voltage rating: 250V AC,DC

Temperature range: -25°C to $+85^{\circ}\text{C}$
(including temperature rise)

Contact resistance: Initial value/ $10\text{m}\Omega$ Max.
After environmental testing/ $20\text{m}\Omega$ Max.

Insulation resistance: $500\text{M}\Omega$ MIN.

Withstanding voltage: 1500V AC/minute

Applicable wire: AWG#26-28

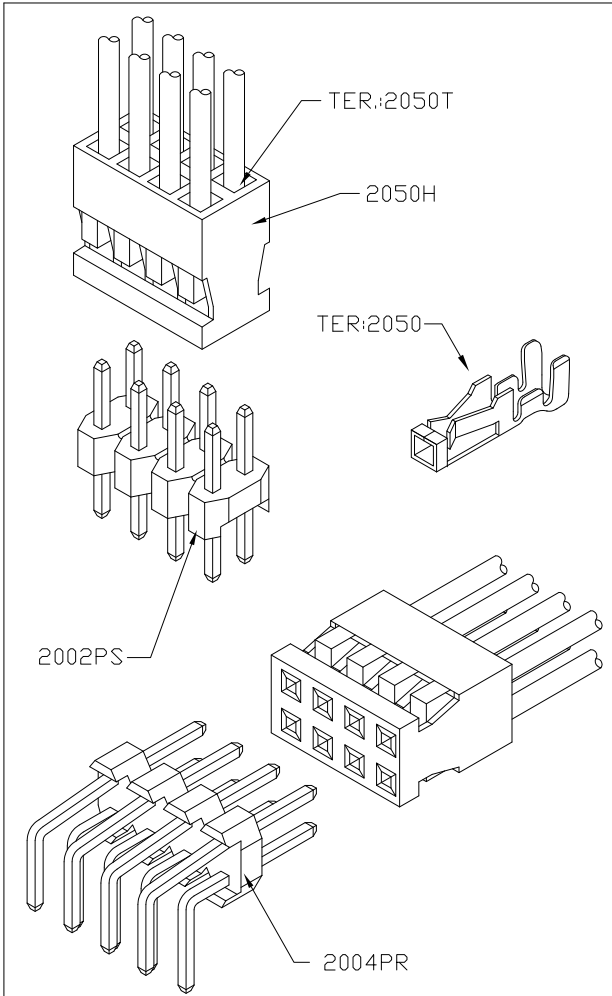

Assembly layout

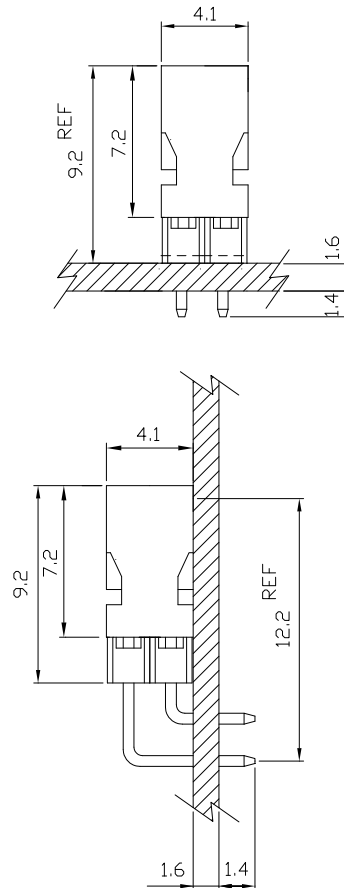

2050H .079" (2.0mm) PITCH CRIMP HOUSING

Features:

unit:mm

- * MAT'L: NYLON 66 UL94V-2
- * MATES WITH 2050 SERIES TERMINAL

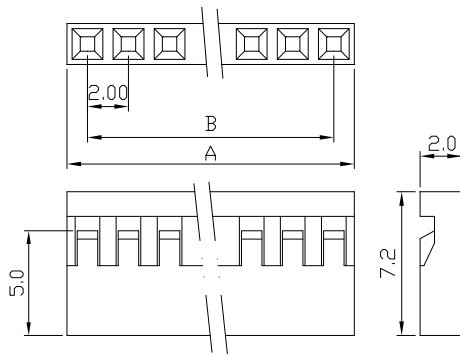

PART NO.	A	B
2050H-1x2	4.0	2.0
2050H-1x3	6.0	4.0
2050H-1x4	8.0	6.0
2050H-1x5	10.0	8.0
2050H-1x6	12.0	10.0
2050H-1x7	14.0	12.0
2050H-1x8	16.0	14.0
2050H-1x9	18.0	16.0
2050H-1x10	20.0	18.0
2050H-1x11	22.0	20.0
2050H-1x12	24.0	22.0
2050H-1x13	26.0	24.0
2050H-1x14	28.0	26.0
2050H-1x15	30.0	28.0

PART NO.	A	B
2050H-1x16	32.0	30.0
2050H-1x17	34.0	32.0
2050H-1x18	36.0	34.0
2050H-1x19	38.0	36.0
2050H-1x20	40.0	38.0
2050H-1x21	42.0	40.0
2050H-1x22	44.0	42.0
2050H-1x23	46.0	44.0
2050H-1x24	48.0	46.0
2050H-1x25	50.0	48.0
2050H-1x26	52.0	50.0
2050H-1x27	54.0	52.0
2050H-1x28	56.0	54.0
2050H-1x29	58.0	56.0

PART NO.	A	B
2050H-1x30	60.0	58.0
2050H-1x31	62.0	60.0
2050H-1x32	64.0	62.0
2050H-1x33	66.0	64.0
2050H-1x34	68.0	66.0
2050H-1x35	70.0	68.0
2050H-1x36	72.0	70.0
2050H-1x37	74.0	72.0
2050H-1x38	76.0	74.0
2050H-1x39	78.0	76.0
2050H-1x40	80.0	78.0

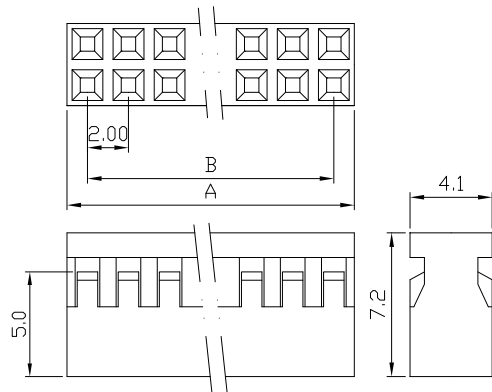

PART NO.	A	B
2050H-2x2	4.0	2.0
2050H-2x3	6.0	4.0
2050H-2x4	8.0	6.0
2050H-2x5	10.0	8.0
2050H-2x6	12.0	10.0
2050H-2x7	14.0	12.0
2050H-2x8	16.0	14.0
2050H-2x9	18.0	16.0
2050H-2x10	20.0	18.0
2050H-2x11	22.0	20.0
2050H-2x12	24.0	22.0
2050H-2x13	26.0	24.0
2050H-2x14	28.0	26.0
2050H-2x15	30.0	28.0

PART NO.	A	B
2050H-2x16	32.0	30.0
2050H-2x17	34.0	32.0
2050H-2x18	36.0	34.0
2050H-2x19	38.0	36.0
2050H-2x20	40.0	38.0
2050H-2x21	42.0	40.0
2050H-2x22	44.0	42.0
2050H-2x23	46.0	44.0
2050H-2x24	48.0	46.0
2050H-2x25	50.0	48.0
2050H-2x26	52.0	50.0
2050H-2x27	54.0	52.0
2050H-2x28	56.0	54.0
2050H-2x29	58.0	56.0

PART NO.	A	B
2050H-2x30	60.0	58.0
2050H-2x31	62.0	60.0
2050H-2x32	64.0	62.0
2050H-2x33	66.0	64.0
2050H-2x34	68.0	66.0
2050H-2x35	70.0	68.0
2050H-2x36	72.0	70.0
2050H-2x37	74.0	72.0
2050H-2x38	76.0	74.0
2050H-2x39	78.0	76.0
2050H-2x40	80.0	78.0

2050 .079" (2.0mm) PITCH CRIMP TERMINAL

Features:

- * THICKNESS: 0.2mm
- * MAT'L: PHOSPHOR BRONZE WITH TIN NICKEL, LEAD OR GOLD PLATING
- * MATES WITH: 2050H SERIES HOUSING
- * ACCEPTS PIN SIZE: 0.5mm (.02") ROUND OR SQUARE PIN
- * ACCEPTS WITH: 2001PS, 2002PS 2003PR, 2004PR SERIES WAFER

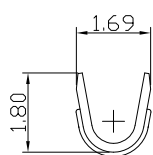

Section A-A

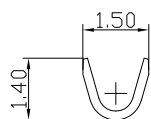

Section B-B

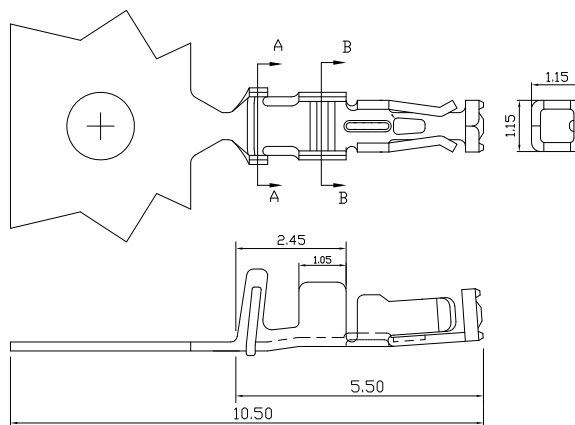

PART NO.	WIRE RANGE	INSULATION O.D.	MATERIAL	FINISH	QTY/REEL
2050-P	AWG#26-#28	1.35mm MAX	PHOSPHOR BRONZE	Tin-plated	20,000