

2520 SERIES

.098" (2.5mm) PITCH BOARD IN CONNECTOR

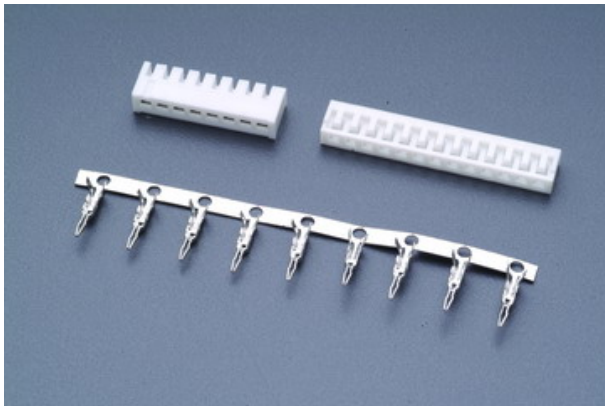

Specifications

Current rating: 3A AC,DC

Voltage rating: 250V AC,DC

Temperature range: -25°C to +85°C
(including temperature rise)

Contact resistance: Initial value/10mΩ Max.

After environmental testing/20mΩ Max.

Insulation resistance: 1000MΩ MIN.

Withstanding voltage: 1000V AC/minute

Applicable wire: AWG#22-28

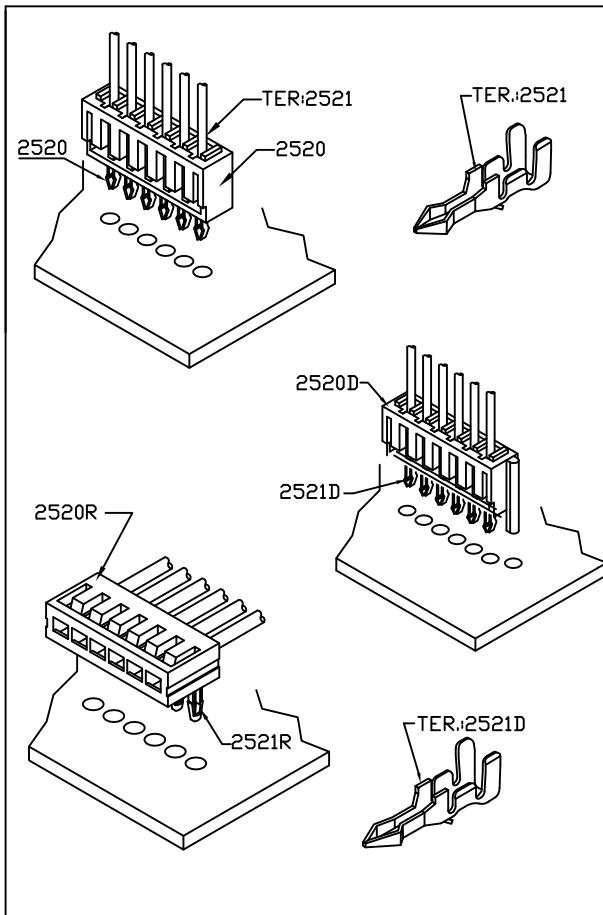

Assembly layout

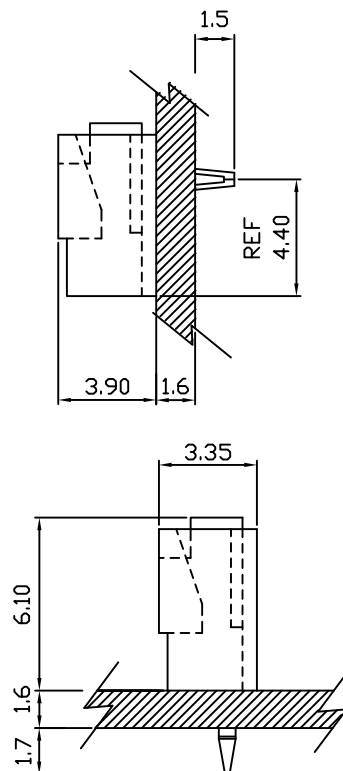

2521D .098" (2.5mm) PITCH CRIMP TERMINAL

Features:

unit:mm

- * THICKNESS: 0.2mm
- * MAT'L: BRASS TIN PLATED
- * USE WITH 1.6mm OR 1.2mm THICKNESS P.C.B
- * MATES WITH: 2520D SERIES HOUSING
- * TERMINAL SOLDER DIRECTLY TO P.C BOARD

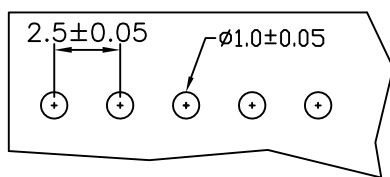
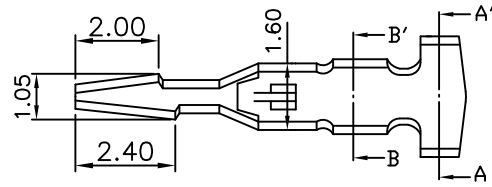
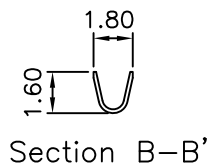
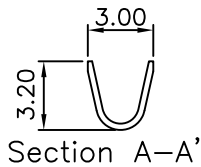

P.C.BOARD LAYOUT

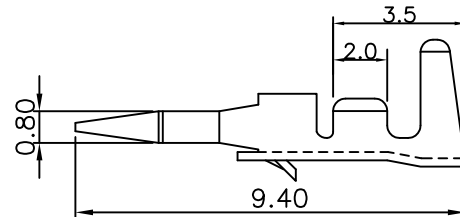

PART NO.	WIRE RANGE	INSULATION O.D.	MATERIAL	FINISH	QTY/REEL
2521D	AWG#22-#28	ø1.9mm MAX	BRASS	Tin-plated	10,000

2521 .098" (2.5mm) PITCH CRIMP TERMINAL

Features:

unit:mm

- * THICKNESS: 0.2mm
- * MAT'L: BRASS TIN PLATED
- * USE WITH 1.6mm OR 1.2mm THICKNESS P.C.B
- * MATES WITH: 2520 SERIES HOUSING
- * TERMINAL SOLDER DIRECTLY TO P.C BOARD

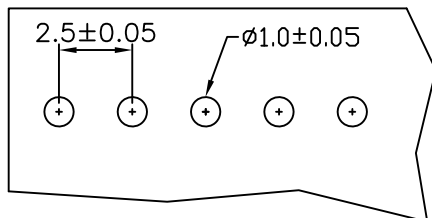
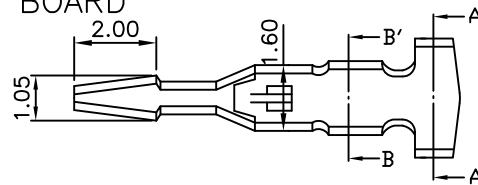
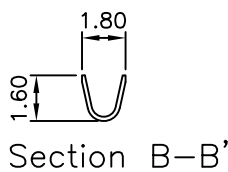
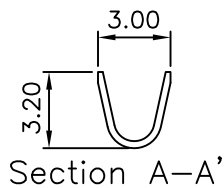

P.C.BOARD LAYOUT

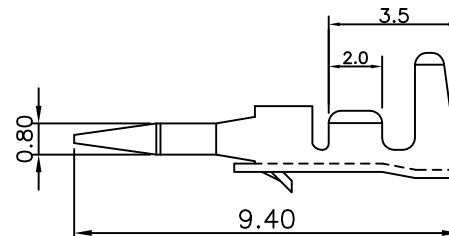

PART NO.	WIRE RANGE	INSULATION O.D.	MATERIAL	FINISH	QTY/REEL
2521	AWG#22-#28	ø1.9mm MAX	BRASS	Tin-plated	10,000

2520 .098" (2.5mm) CRIMP HOUSING

Features:

unit:mm

- * MAT'L: NYLON 66 UL94V-0
- * MATES WITH: 2521 2521D SERIES TERMINAL

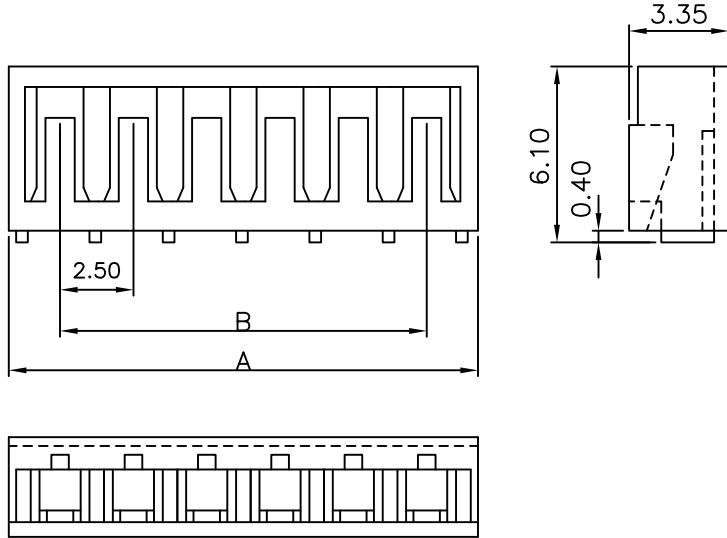

PART NO.	A	B
2520-02	6.5	2.5
2520-03	9.0	5.0
2520-04	11.5	7.5
2520-05	14.0	10.0
2520-06	16.5	12.5
2520-07	19.0	15.0
2520-08	21.5	17.5
2520-09	24.0	20.0
2520-10	26.5	22.5
2520-11	29.0	25.0
2520-12	31.5	27.5
2520-13	34.0	30.0
2520-14	36.5	32.5
2520-15	39.0	35.0
2520-16	41.5	37.5

2521R 2521SR .098" (2.5mm) PITCH CRIMP TERMINAL

Features:

unit:mm

- * THICKNESS: 0.2mm
- * MAT'L: BRASS TIN PLATED
- * USE WITH 1.6mm OR 1.2mm THICK P.C BOARD
- * MATES WITH: 2520R SERIES HOUSING
- * TERMINAL SOLDER DIRECTLY TO P.C BOARD

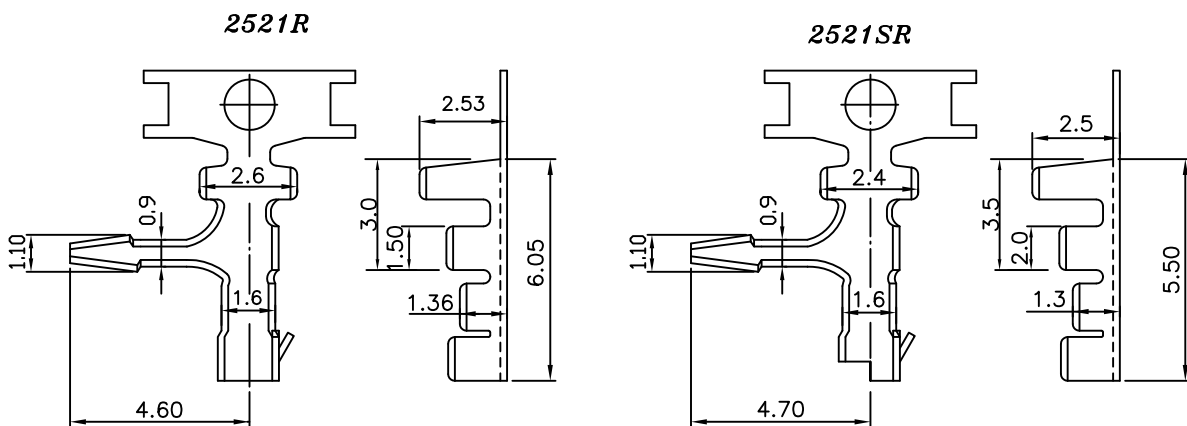
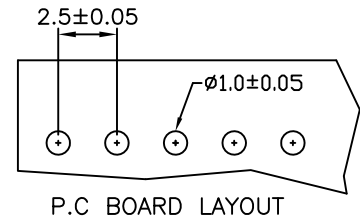

PART NO.	WIRE RANGE	INSULATION O.D.	MATERIAL	FINISH	QTY/REEL
2521R	AWG#22-#28	Ø1.9mm max	BRASS	Tin-plated	10,000
2521SR	AWG#22-#28	Ø1.9mm max	BRASS	Tin-plated	10,000

2520R .098" (2.5mm) CRIMP HOUSING

Features:

unit:mm

- * MAT'L: NYLON 66 UL94V-0
- * MATES WITH: 2521R SERIES TERMINAL

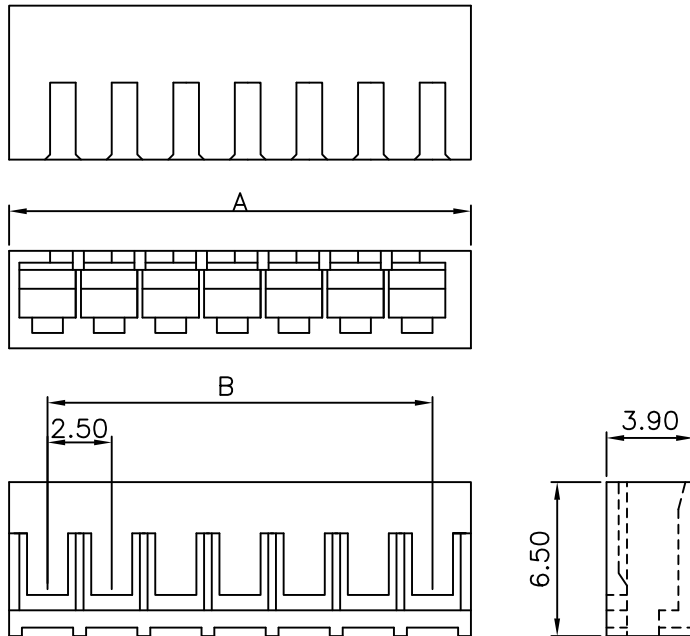

PART NO.	A	B
2520R-02	6.5	2.5
2520R-03	9.0	5.0
2520R-04	11.5	7.5
2520R-05	14.0	10.0
2520R-06	16.5	12.5
2520R-07	19.0	15.0
2520R-08	21.5	17.5
2520R-09	24.0	20.0
2520R-10	26.5	22.5
2520R-11	29.0	25.0
2520R-12	31.5	27.5
2520R-13	34.0	30.0
2520R-14	36.5	32.5
2520R-15	39.0	35.0
2520R-16	41.5	37.5

2520D SERIES .098" (2.5mm) PITCH CRIMP TERMINAL HOUSING

Features:

unit:mm

- * MAT'L: NYLON 66 UL94V-0
- * MATES WITH: 2521D SERIES TERMINAL

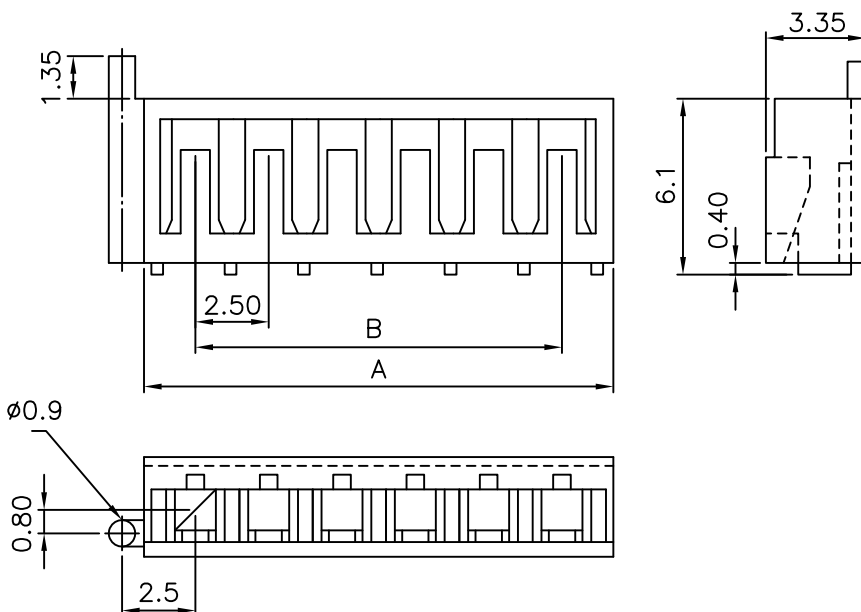

PART NO.	A	B
2520D-02	6.5	2.5
2520D-03	9.0	5.0
2520D-04	11.5	7.5
2520D-05	14.0	10.0
2520D-06	16.5	12.5
2520D-07	19.0	15.0
2520D-08	21.5	17.5
2520D-09	24.0	20.0
2520D-10	26.5	22.5
2520D-11	29.0	25.0
2520D-12	31.5	27.5
2520D-13	34.0	30.0
2520D-14	36.5	32.5
2520D-15	39.0	35.0
2520D-16	41.5	37.5