

8611 .200" (5.08mm) PITCH CRIMP TERMINAL

Features:

- * THICKNESS: 0.25mm
- * MATES WITH: 8621H-04 SERIES HOUSING
- * ACCEPT WITH: 8610 TERMINAL & 8620H-04 HOUSING

unit:mm

8611
8611L

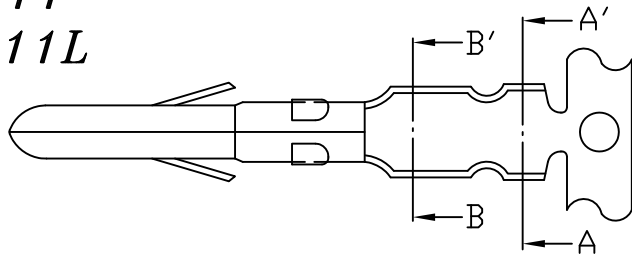

8611-1

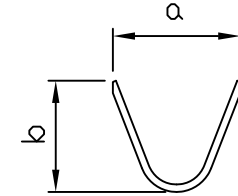
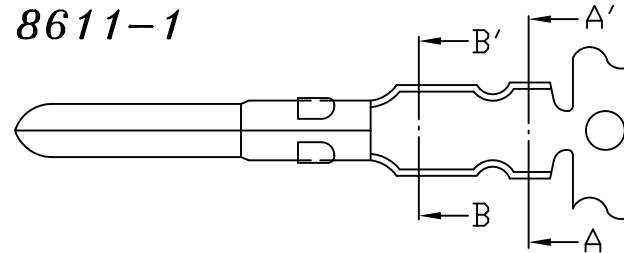

Section A-A'

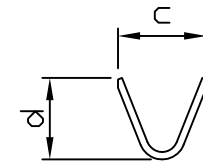

Section B-B'

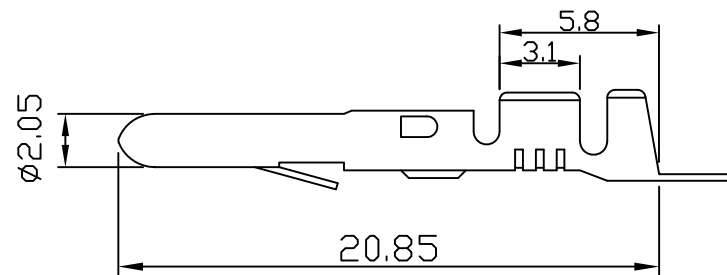
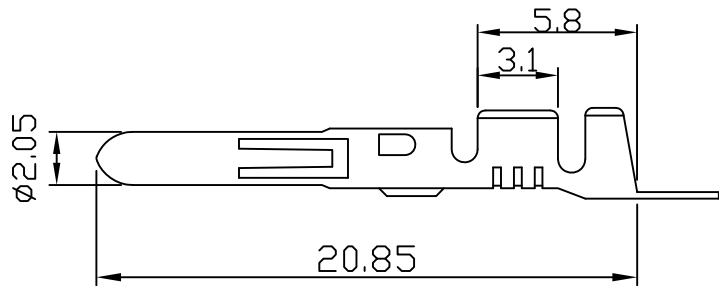

PART NO.	a	b	c	d
8611-1 8611	4.1	3.3	3.4	2.8
8611L	4.85	4.1	3.0	3.5

PART NO.	WIRE RANGE	INSULATION O.D.	MATERIAL	FINISH	QTY/REEL
8611-1	AWG#18-#22	$\phi 2.8 \sim \phi 1.5 \text{mm}$	BRASS/ PHOSPHOR BRONZE	Tin- plated	8,000
8611	AWG#18-#22	$\phi 2.8 \sim \phi 1.5 \text{mm}$	BRASS/ PHOSPHOR BRONZE	Tin- plated	8,000
8611L	AWG#14-#18	$\phi 4.2 \sim \phi 2.8 \text{mm}$	BRASS/ PHOSPHOR BRONZE	Tin- plated	5,000