

1011H 1011SL 1013 .394" (10mm)x.315" (8mm) PITCH CRIMP TERMINAL

unit:mm

Features:

- * THICKNESS: 0.25mm
- * MAT'L: BRASS TIN PLATED
- * MATES WITH: 1080 SERIES HOUSING

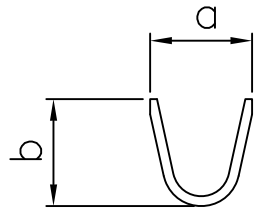

Section A-A'

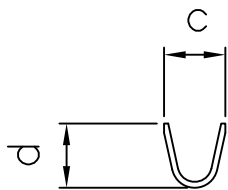

Section B-B'

PART NO.	a	b	c	d
1011H 1011SL	3.8	3.5	2.8	2.5
1013	4.6	4.0	2.4	2.7

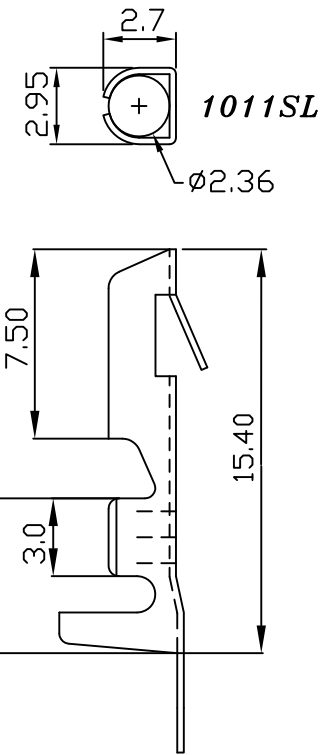
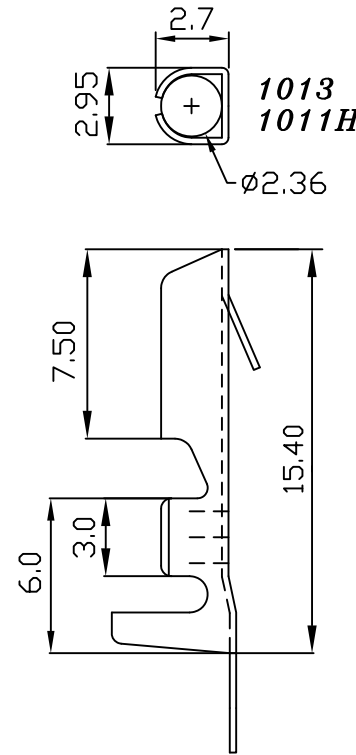
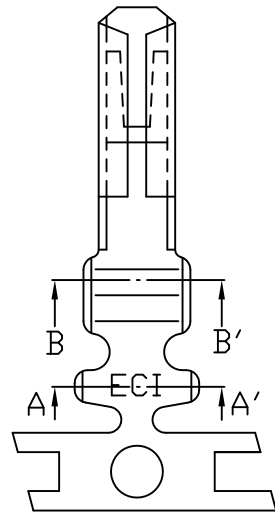

PART NO.	WIRE RANGE	INSULATION O.D.	MATERIAL	FINISH	QTY/REEL
1011H 1011SL	AWG#18-22	ø2.54 mm MAX	BRASS	Tin-plated	7,000
1013	AWG#18-22	ø2.80 mm MAX	BRASS	Tin-plated	7,000