

8610 8614 .200" (5.08mm) PITCH CRIMP TERMINAL

unit:mm

Features:

- * THICKNESS: 0.25mm
- * MATES WITH: 8620-04 SERIES HOUSING
- * ACCEPT WITH: 8611 TERMINAL & 8621-04 SERIES HOUSING
- * 8610:T:0.25T 0.30T

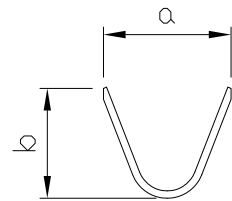

Section A-A'

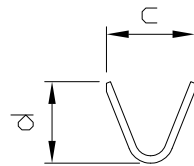

Section B-B'

	a	b	c	d
8610	4.10	3.30	2.70	2.40
8614	4.80	4.30	3.10	3.40

8610
8614

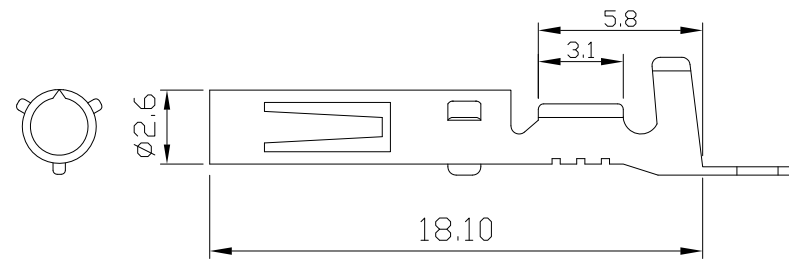
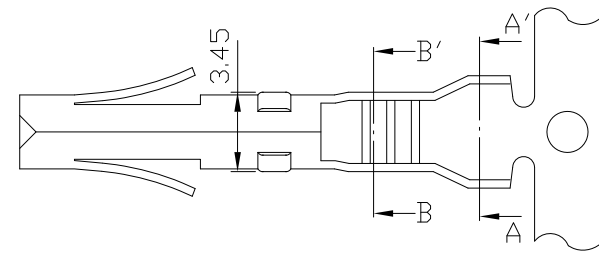

PART NO.	WIRE RANGE	INSULATION O.D.	MATERIAL	FINISH	QTY/REEL
8610	AWG#18-#22	φ2.8~φ1.5mm	BRASS/ PHOSPHOR BRONZE	Tin- plated	8,000
8614	AWG#16-#18	φ4.2~φ2.8mm	BRASS/ PHOSPHOR BRONZE	Tin- plated	5,000