

# 7511 7513 .295"(7.5mmX5.0mm) PITCH CRIMP TERMINAL

unit:mm

## Features:

- \* THICKNESS: 0.25mm
- \* MAT'L: BRASS OR PHOSPHOR BRONZE TIN PLATED
- \* MATES WITH: 7550 SERIES HOUSING
- \* ACCEPTS WITH: 7551 SERIES WAFER

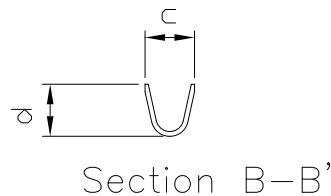
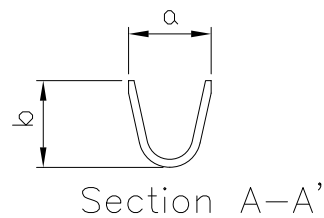

PART NO.	a	b	c	d
7511	3.0	3.60	2.2	2.3
7513	4.0	4.2	2.3	2.3

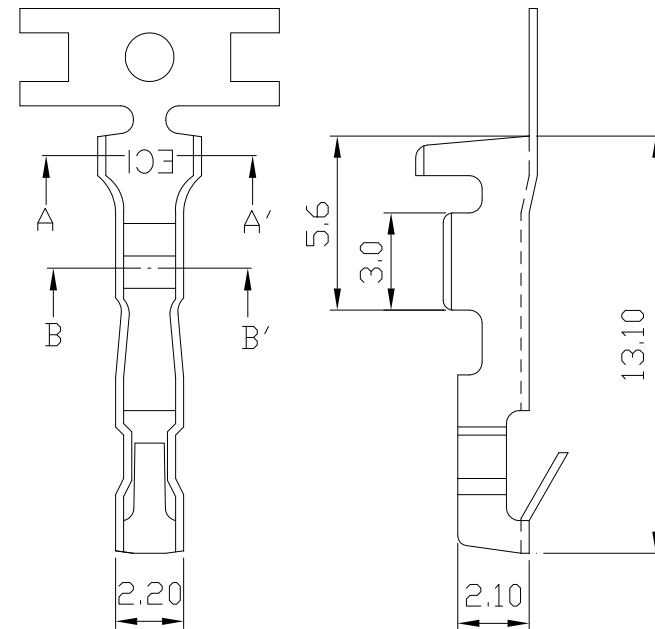

PART NO.	WIRE RANGE	INSULATION O.D.	MATERIAL	FINISH	QTY/REEL
7511	AWG #18-#22	ø2.45mm max	BRASS	Tin-plated	8,000
7511-P	AWG #18-#22	ø2.45mm max	PHOSPHOR BRONZE	Tin-plated	8,000
7513	AWG #12-#16	ø2.8mm max	PHOSPHOR BRONZE	Tin-plated	8,000