

# 5015 1.65" (4.2mm) PITCH CRIMP TERMINAL

Features:

unit:mm

- \* THICKNESS: 0.2mm
- \* MAT'L: BRASS TIN PLATED
- \* MATES WITH: 5015H SERIES HOUSING

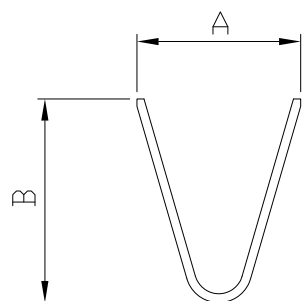

Section A-A'

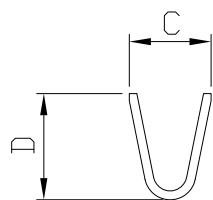

Section B-B'

PART NO.	A	B	C	D
5015T1	3.7	4.6	2.0	2.4
5015T2	2.8	3.4	1.8	2.45

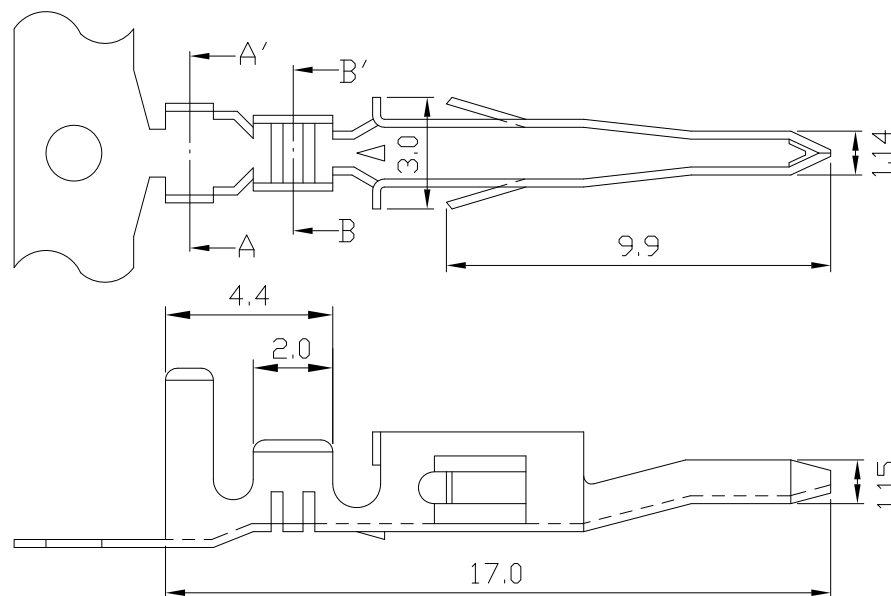

PART NO.	WIRE RANGE	INSULATION O.D.	MATERIAL	FINISH	QTY/REEL
5015T1	AWG#18-#22	ø2.8mm Max	BRASS	Tin-plated	5,000
5015T2	AWG#22-#24	ø2.0mm Max	BRASS	Tin-plated	5,000